

YRW 600 Amber LED Series



Features and Characteristics

Alumilite offers a full line of Sea Turtle and Observatory Friendly luminaires that are produced from high grade aluminum and finished with Super Durable Polyester Powder. The Amber LED modules meet the specifications of the Florida Wild Life Commission.

Housing: Extruded aluminum tube with .125" wall thickness is welded to the arm bracket.

Lens Assembly: Clear heat tempered glass lens is sealed in regressed cast aluminum frame which is gasketed and secured to the housing with three flush stainless steel set screws. Optional with frosted glass lens "FG".

Mounting Bracket: Extruded aluminum arm is internally welded to cast cover plate and to the housing. Steel zinc-plated bracket mounts to the wall surface and is secured to the cast cover with two stainless steel fasteners. Optional for surface ceiling mounting "SM".

Module/Driver: Amber LED linear modules have a minimum wavelength of 583 nm. They are available in 14 watt 700 lumens. Drivers have Class 2 power, universal voltage and are IP 67 rated LED module/driver has a 5-year limited warranty.

Finish: Polyester powder coating on all metal parts. Color to be specified.

Listing: Luminaire is ETL listed for wet locations and has been approved by the FWC. Certification #2018-034.

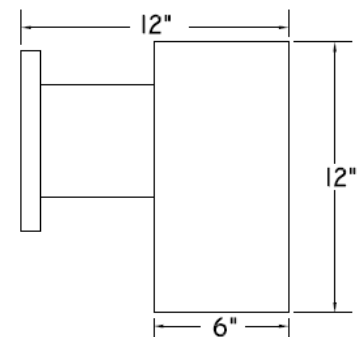
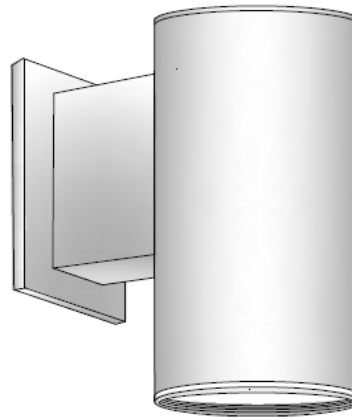

Specifications

Series	Wattage/Lamp	Volts
YRW	14w/ALED = 614/ALED	UV

Options	Finish
FG = Frosted Glass	BZ = Bronze
PH = Photo Cell	BK = Black
SM = Surface Mount	WH = White
	SL = Silver
	CC = Custom Color

Example

14 Watt, Amber LED, 120 Volt, Photo Cell, Bronze
YRW-614/ALED-UV/PH/BZ