

Features and Characteristics

Alumilite designs reliable products produced with the best available materials, and we stand behind them with superior customer service. Please contact us for more information.

Housing: Heavy gauge aluminum housing is internally welded and sealed to prevent water entry or light leaks. Housing is bolted directly to the wall.

Lens Frame: Formed from extruded aluminum, the frame rests on gasketed support frame in housing. Lens frame is secured to the housing with two stainless steel tamper proof fasteners. Clear heat tempered glass lens is gasketed and secured in the frame with (4) clips. Frosted glass "FG" is optional.

Mounting: Steel plate bolts to the wall and the housing bolts to the plate. Module/Driver assembly are attached to the inside back of the housing.

Module/Driver: HPWinner LED Modules have high quality Lumiled LED's with an IP-68 rating and waterproof connectors. They are available in type 3 and type 4 distributions with 35w/4500lm or 55w/6100lm. Modules are available in 3000, 4000 and 5000k and have a minimum CRI of 80. Drivers are 0-10v dimming with universal voltage. Extruded aluminum heat sinking system provides optimal thermal management.

Finish: Polyester powder coating on all metal parts. Color to be specified.

Listing: Luminaire is ETL listed for wet locations

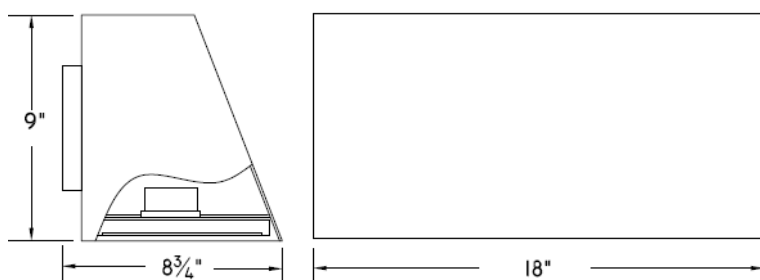
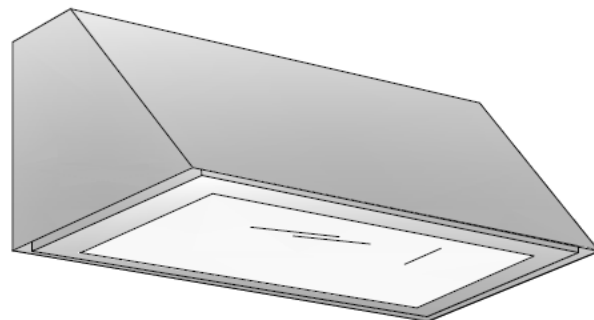

Specifications

Series	Wattage/Lamp	Volts
SV 1	35w/LED = 35/LED	UV
SV 1	55w/LED = 55/LED	UV

Options	Finish
3000k = 30k	BZ = Bronze
4000k = 40k	BK = Black
5000k = 50k	WH = White
R3 = Type 3 Distribution	SL = Silver
R4 = Type 4 Distribution	CC = Custom Color
FG = Frosted Glass	
PH = Photo Cell	

Example

35Watt, LED, 120 Volts, 3500k, Type 3, Bronze
SV-135LED-UV/35k/R3/BZ